

\*) MEASURING FORCE IF THE GAUGE IS HELD  
IN MEASURING POSITION AS SHOWN ABOVE

B ( 1 : 2 )

ADJUSTABLE STOPPER

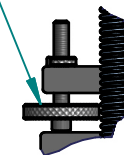

subject to technical alterations

type: **Modul 2**  
range: 0 - 200 mm  
range of indication: 0 - 201 mm  
digital step: 0,2 mm  
scale interval: -  
measuring force: 0,8 - 1,5 N \*)  
weight: 1,3 kg

acceptable deviations  
VDI/VDE/DGQ 2618 Bl. 12.1/13.1)  
max. permissible  
errors "G": 0,4 mm  
repeatability "r": 0,2 mm  
reference temperature: 20° C  
operation temperature: 10° C - 30° C  
storage temperature: -10° C - 50° C

scale: 1:5 (1:2)  
drawing-nr.: DAB-C16200\_KR\_e  
date of issue: 30.03.2015  
name: J.Röder  
revision status: 2129  
revision date: 12.01.2016 (MHe)